

INSTALLATION INSTRUCTIONS FOR VALLEY CEDAR SHINGLE PANELS

VALLEY CEDAR 2 INC * 1127 HERRING GULL WAY PARKSVILLE BC
CANADA * V9P 1R2 * 250-248-2436 * www.valleycedarpanels.com



R-value test rating report for LEEDS program & Engineering report for code approvals are available upon request.

Supplies you may require that we do not provide: 3/8" thick base starter strips or sheathing. For outside wall corners there are 3 options on page 2. For inside corner boards, 1x1 or 2x2 wood strips will be needed.

Pre-fab flush corners- if you are installing our 90 degree flush corners, refer to page 2 for corner installation, these must be installed as you go along and cannot be set after panels. If using moulding boards for corners these also need to be set in place before panel installation.

“NAIL ZONE” AREA

There is a line scribed across the top of each panel as a nailing area guide for nail placement. Make sure to drive all nails a hair above the scribed line and into the stud! This ensures optimum wind uplift resistance while concealing the fastener with the next row.

NAILING INSTRUCTIONS:

Use a ring shank corrosion resistant siding nail with length of 6D to 8D ideally Maze brand #R-107-A 2.5-inch (*galvanized or stainless steel*) Nail the panels 1" to 1-1/8" down from the top STARTING 1/2 inch in from one edge and working across the panel. Never nail from both edges towards the middle. Each nail *MUST* be driven through the shear into the 2X4 stud or a second nail must be added. Nail head should be flush with the surface of the panel. Panel ends need to join on studs or rafters, and the nails holding panels must be driven into studs! For air nail guns, adjust pressure & **Do Not Overdrive Nails!**

When panels are cut on angles to fit gables, under windows, outlets or other cut-out spaces which **eliminate the top staple line or any of the backside staples, it MUST BE RE-STAPLED in its new form EXACTLY as prior or the integrity of the product will be compromised & manufacturer's warranty void.** New top staple lines *must be 1/4" crown stainless steel for this exposed application.* (**Suggestion: draw out a template on the panel, tack the new top staple line of shingles in place before cutting off the original top staple line**)

Plan panel layout from lowest building elevation. Hold panels 6" off grade and 1" off decks, 2" off roofs but tight to window or door trim. Panels must be applied over 1/2" nailable shear sheathing fastened onto studs (or equivalent), max 16" O.C. A code approved moisture barrier must be applied directly behind the panels. Use a level as you go: **Set your starter strip base – Use 3/8" thick wood strips or sheathing to set your level base row. Next, if you have inside corners, install these pieces too.** Panels must span at least one stud spacing and vertical end joints must be staggered so they do not land on the same stud. **Installing shingle wall panels is very similar to installing plank flooring.**

RECREATING KEYWAYS & END-LAP JOINTS:

When matching smaller sections or needing to recreate a keyway to match to a corner piece, save your offcuts and simply make a cut with enough overlap to match the keyway size - caulk up to corners and mouldings. Note: Our shingle panels have a built-in fiberglass-waterproof barrier layer, essentially the undercourse. Should any keyways line up, it will in no way compromise the product and is completely fine and code compliant for our product.



Above is typical installation to rainscreen strapping

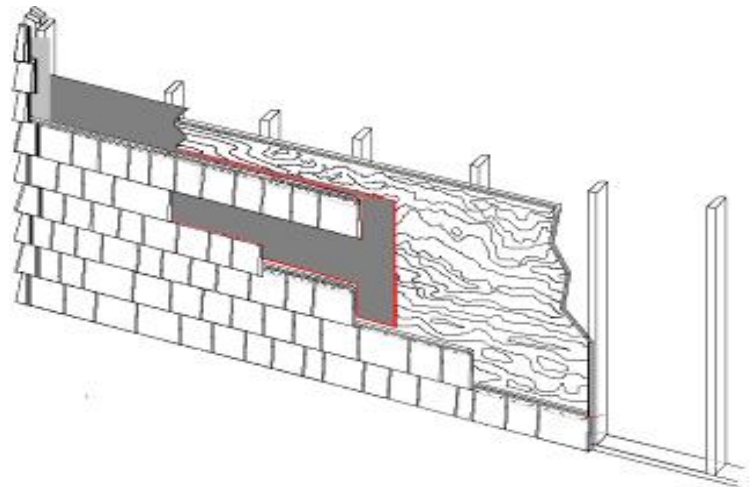

Gable with exposed nail application to angle cuts

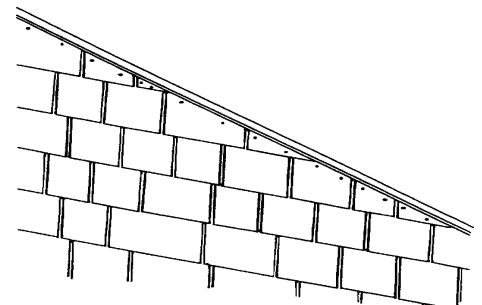

INSTALLATION INSTRUCTIONS FOR VALLEY CEDAR SHINGLE PANELS

VALLEY CEDAR 2 INC * 1127 HERRING GULL WAY PARKSVILLE BC
CANADA * V9P 1R2 * 250-248-2436 * www.valleycedarpanels.com



FLUSH 90 DEGREE CORNERS: (Install before panels/ as you go along with panels)

The Boston hip alternating lap corner construction is used where the corner overlap alternates with each course. Flush-mounting Corner units have 8 pcs per bundle and are supplied in four different alternating widths (marked A,B,C,D) so that the vertical corner line is eliminated. Install corner first. Double wrap building corners with moisture barrier. Attach corners using the recommended fasteners, 1.5" down from top edge, centered on each side. Apply the 4 marked corner units provided in order A,B,C,D (repeating). Start with any piece but retain the order or the "Boston Weave" will be off. Caulk corner plywood edges well. Trim panel end and push against caulked corner edge. **Key way can be re-created by cutting close up to the next shingle, but revealing the desired keyway underlap**

90 DEGREE FLUSH CORNER

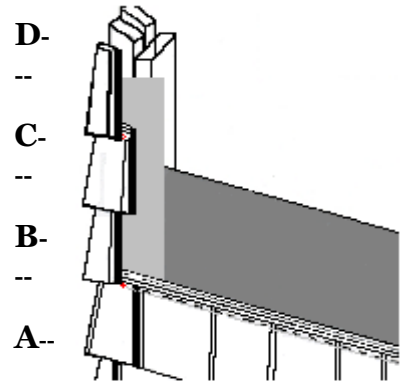

ADD-ON CORNERS: (Install after panels)

Add-on corner units are pre-fabricated, 8 pieces per bundle. Add-on corners require starter pieces made on-site from individual cedar shingles. (NOT SUPPLIED BY MANUFACTURER) With **Add-on corners**, install all panels first, positioning so that panel ends are flush with corner without overlap. (Panel ends do not need to be trimmed.) Double wrap building corners and apply corners using one nail per corner side, 1" down from top course only.

ADD ON CORNER

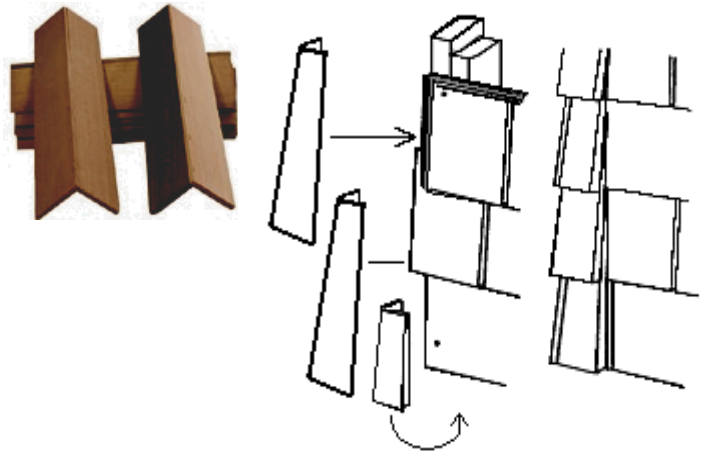

INSIDE CORNERS:

NOT SUPPLIED BY MANUFACTURER. If your project has inner corners, you will need 1.5x1.5 or 2x2 wood pieces (pre-stain) and nail pieces into the inside home corners BEFORE starting panel installation. Caulk sufficiently where the panel will butt against it. Trim panel end square and set panel against the strip. **Use caution that caulk does not squeeze out onto face of panel**

INSIDE CORNER

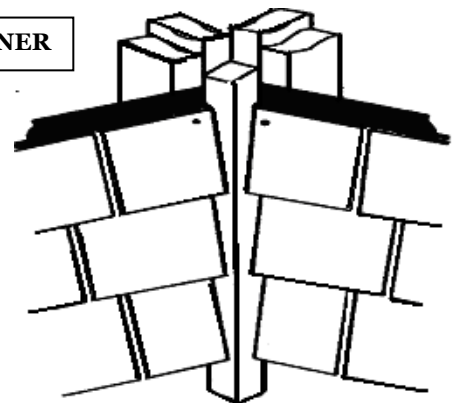

MOULDING CORNERS:

NOT SUPPLIED BY MANUFACTURER. It is not necessary to use our prefabricated shingle corners with the panels. Moulding trim is also an option. Install trim, cut panel end square, caulk and set panel against the moulding trim.

MOULDING TRIM

